

Gateway IoT WiFi

7860676-04 15-11-2024

1a

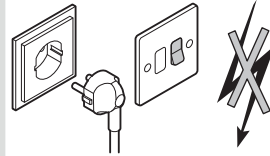
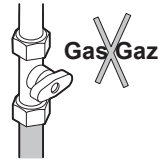

1b

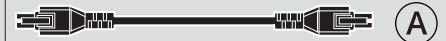
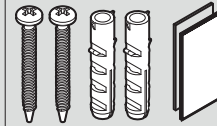
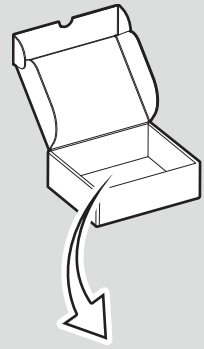

2

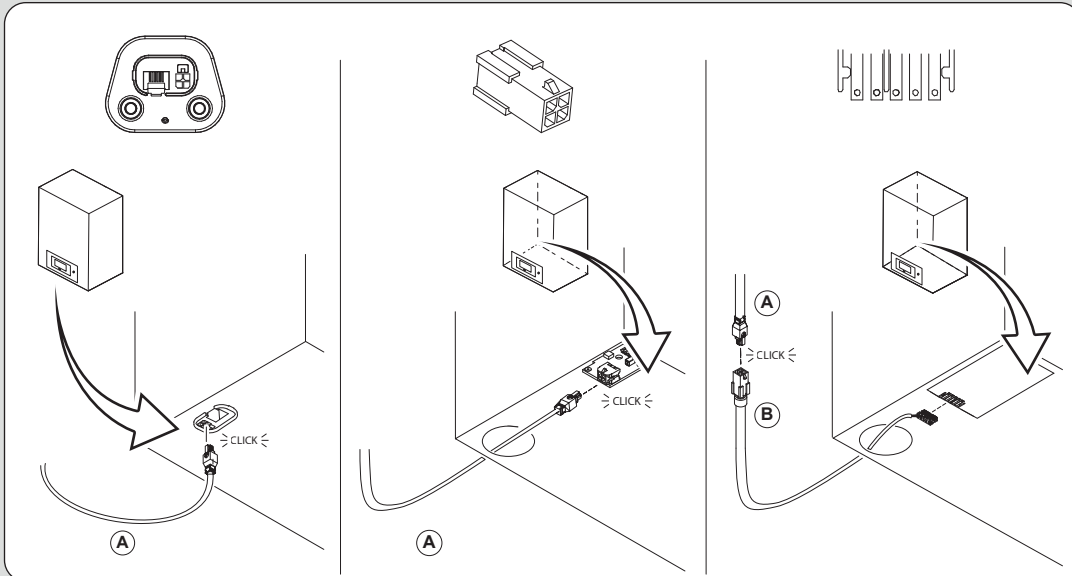

3

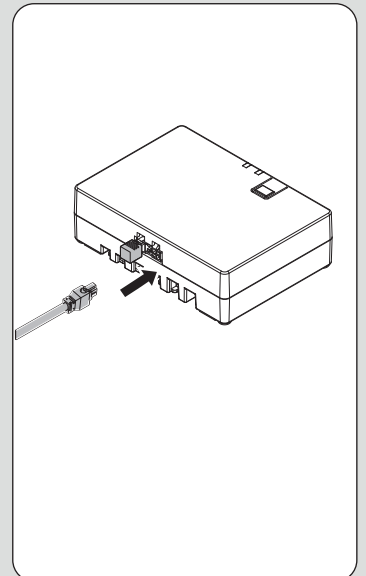

4a

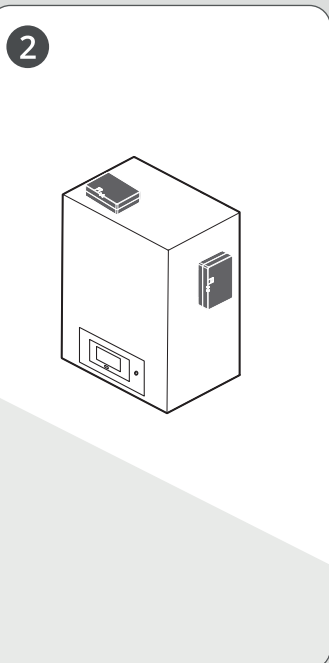
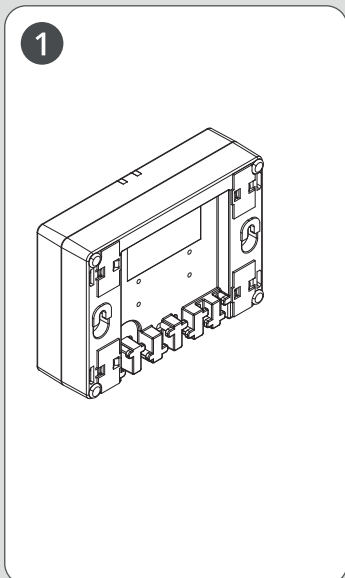

4b

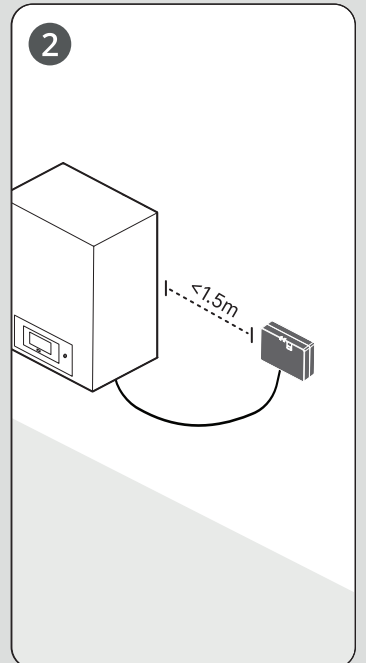
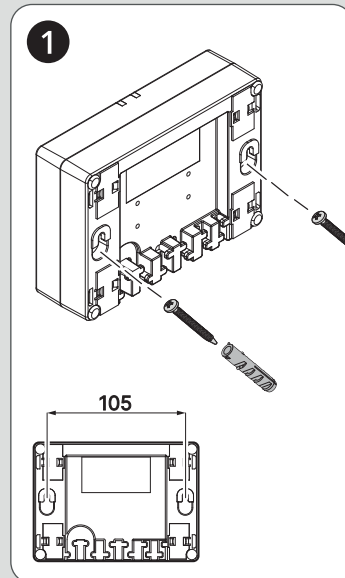

5a

1

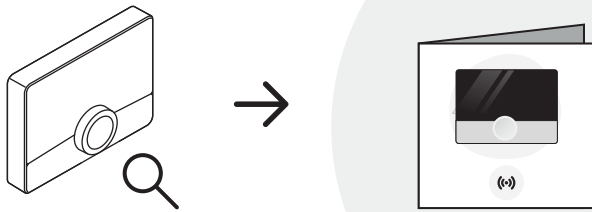

5b 

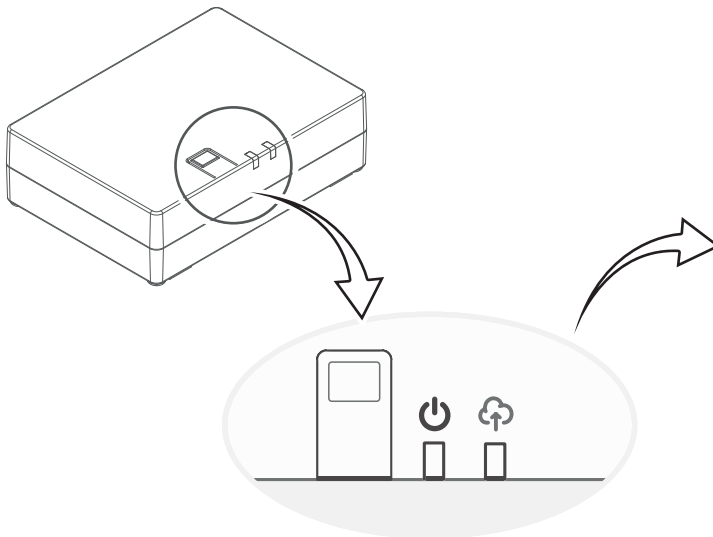
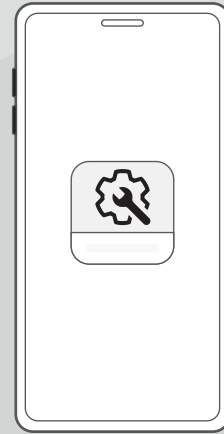

Frequency Band (Mhz)	Mode	Output Power E.I.R.P (dBm)
2400-2483.5	WLAN (2.4G Wi-Fi)	17.7
2400-2483.5	BLE	8.5
2400-2483.5	Zigbee	8.5

The device complies with RF exposure guidelines when at a minimal distance of 20cm from a person.

Apple and the Apple logo
are trademarks of Apple Inc.

Google Play and the Google Play logo are trademarks of Google LLC.



Hereby, BDRThermea Group B.V. declares that the equipment type Gateway IOT is in compliance with Directive 2014/53/EU and S.I. 2017/1206. The full text of the EU and UK declaration of conformity is available at the following address: <https://declaration-of-conformity.bdrthermeagroup.com>

The Bluetooth® word mark and logos are registered trademarks owned by Bluetooth SIG, Inc. and any use of such marks by BDR Thermea Group B.V. is under license. Other trademarks and trade names are those of their respective owners.